



4-H SUMMER PROGRAM GUIDE



Open to all youth who have completed Grades K-12!

Get registered for Wilkin County's 2025 Summer Programs!

Our summer programs are open to ALL youth; joining **a club is not required**. However, enrolling as a member is required for participation in all programs and events to meet our risk management policies. If your *child is not currently enrolled in Wilkin County 4-H*, please enroll as an event member using the instructions provided.

Please have your enrollment and event registrations completed one week before the start of each program!

Have questions? The Wilkin County Extension staff are here for YOU! Please, reach out with any questions that you have at 218-643-5481 or mnext-wilkin@umn.edu. We are committed to helping your family have a fun & successful 4-H experience.

See you this summer!

View this document online at: z.umn.edu/25SummerProgramGuide

web | z.umn.edu/Wilkin4H • Facebook | fb.me/Wilkin4H



How to enroll and register for an event

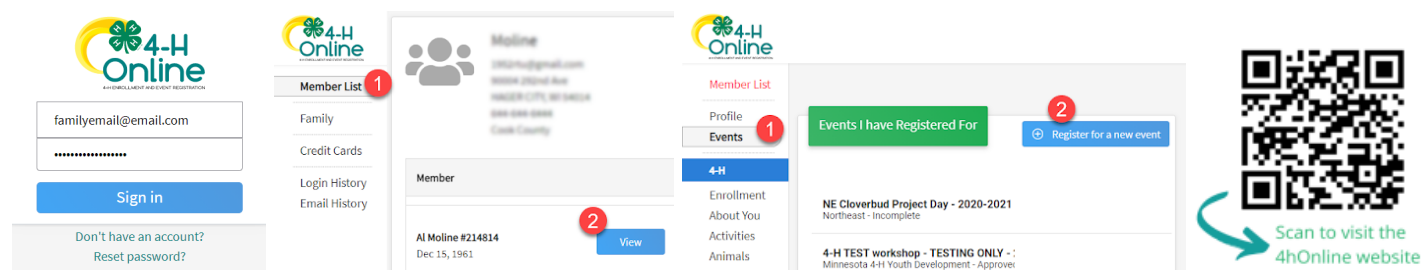

Step 1 (skip to step 2 if your child is already a member)

- Visit <https://mn.4honline.com> or scan the QR code at the top of this page.
- Log into your family 4hOnline account or create a new account if you are not an existing member
- After logging in to your family profile in 4hOnline, click on the Member List. Click 'View' on the member you would like to register
- Select "In-person 4-H Camp/Event" as your club
- In the projects field, select project areas based on your child's interests.
 - ◦ Cloverbuds (grade K-2)--choose "Cloverbud General" and/or "Cloverbud Animal"
 - ◦ 4-H Youth (grades K-13)--choose "Explore all of 4-H" or any of the project areas listed that your child will be interested in learning about
- Once your enrollment is reviewed and approved, you will be notified via email

Step 2

- **After receiving the enrollment approval email**, log back into your 4hOnline account
- Click on 'Member List' and view the member you would like to sign up for the event
- From the member's profile, click on 'Events' and 'Register for a New Event'
- Select the name of the event you are signing up for and the session/type you wish to register for
- Click 'Start Registration' and complete the registration questions as prompted
- If applicable, select the payment method to pay any fees that are associated with the registration. In some cases, you can use a Credit Card, but not all events are able to offer that option. In those cases please mail a check payable to Wilkin County 4-H to Wilkin County 4-H, 300 5th St, Breckenridge, MN 56520
- Click the 'Finish' button

Becoming a member

Completion of **enrollment** is required for participation in **ALL programs** to meet our risk management & safety of minors policy. If your *child is not currently enrolled in Wilkin County 4-H*, they will have to *enroll before you can sign up for an event or activity*. The steps outlined above will complete both your enrollment and event registration. This [enrollment guide](#) provides a more detailed enrollment step-by-step process.

Register for an event

Please note that registering for events will not be available until after your enrollment is completed and approved in 4hOnline. The enrollment review typically takes **24 to 48 hours for approval**. You will receive an email notice after the enrollment is approved. Now you can log back into 4hOnline to register for the event of your choice! This [event registration guide](#) provides a more detailed step-by-step process

Project Workshops for grades 3+

Beginners Crochet!

Let's learn to crochet! We will provide the yarn, hooks, and instructions. You should bring curiosity, a love of fiber, and patience. Youth will learn basic crochet skills: how to make a slip knot, single stitches, finishing techniques, and how to read patterns to create a simple crochet project.

Register online in [4hOnline](#) at least one week in advance.

Dates, times and location of program

Date(s): July 22

Time(s): 10 to 12 p.m.

Location(s): Welles Memorial Park, 101 Nebraska Ave, Breckenridge, MN

Target age/grade range of participants

Grades: 3-5 (2024-2025 school year)

Minimum/maximum number of participants

Min 6 / Max 14



Oh Snap!

Time to snap some pics! Learn some tricks of the trade from a professional photographer. No fancy camera necessary. Just bring your smartphone or personal camera and be ready to take some photos.

Register online in [4hOnline](#) at least one week in advance.

Dates, times and location of program

Date: July 14

Time: 9 a.m. to 12 p.m.

Location: Welles Memorial Park, 101 Nebraska Ave., Breckenridge, MN

Target age/grade range of participants

Grades: 3-13 (2024-2025 school year)

Minimum/maximum number of participants

Min 6 / Max 14



Project workshop for grades 6+!

Side Table Swager

Turn a basic cake pan to a stylish and handy table. Youth will have the opportunity to learn basic woodworking and design skills as they personalize their tables with spray paint and wood stain and then put all the pieces together into their one-of-a-kind side table.

Register online in [4hOnline](#) at least one week in advance.

Dates, times and location of program

Date(s): July 15

Time(s): 10 to 12 p.m.

Location(s): Welles Memorial Park, 101 Nebraska Ave, Breckenridge, MN

Target age/grade range of participants

Grades: 6-13 (2024-2025 school year)

Minimum/maximum number of participants

Min 6 / Max 14



Wilkin County 4-H Camps

Cloverbud Day Camps for grades K-2

Who's ready for adventure? Your Cloverbud can have a blast at Cloverbud Day Camp! Youth who have completed grades K-2 can join us for either of the day camp sessions held in Breckenridge and Campbell, MN. Cloverbuds will leave each camp with two projects suitable for the fair.

Register online in [4hOnline](#) at least 1 week in advance.

Dates, times and location of program

Sessions:

June 23, 2025—at the Welles Memorial Park, 101 Nebraska Ave, Breckenridge, MN

June 24, 2025—at the Campbell Community Center, 502 Main St., Campbell, MN

Time: 10 to 2 p.m

Target age/grade range of participants

Grades: K-2 (2024-2025 school year)

Requirements for participation in Cloverbud Day Camps:

Youth will need to bring a sack lunch & refillable water bottle for each camp session. Please dress appropriately for the weather, outside play & camp activities. Each camp will have hands-on learning activities, social & recreational game time, recreational game time, and healthy snacks.

Summer Horse Project for grades K-13

Horse Practice

Are you passionate about horses? Then saddle up your horse and join the Wilkin County 4-H project leaders to learn basic skills for working with your horses in a safe & fun environment. Each date will include learning about equine husbandry, riding skill practice for games classes, pleasure riding, and showmanship!

Register online in [4hOnline](#) for horse project and contact the Wilkin County Extension Office for further details.

Dates, times, and location of program

Date(s): Mondays June - August

Time(s): 6:30 to 8:30 p.m.

Location(s): Red River Riders Arena, 1952 360th St, Breckenridge, MN

Target age/grade range of participants

Grades: K-13 (2024-2025 school year)

Minimum/maximum number of participants

Min 6 / Max 30

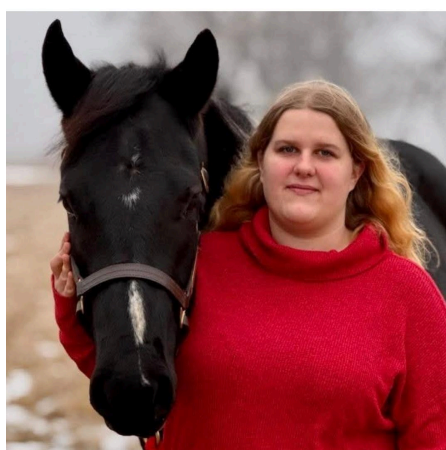

Safety policy for participation in all horse practices

All youth must wear closed-toe shoes with a heel (boots), jeans (leggings are not acceptable), and a t-shirt. A sweatshirt or light jacket is strongly suggested. All youth participating in mounted activities are required to wear properly fastened ASTM/SEI-approved protective headgear with chin straps. Helmet use is required when mounted.

You're Invited!

Wilkin County Showcase–August 7, 2025

Did you know that **all youth who participate in our county summer programs are making projects that can be exhibited at the Wilkin County Showcase?** ALL youth who exhibit with Wilkin County 4-H during the showcase can earn RIBBONS and CASH for EVERY exhibit they bring! Your child(ren) already put in all the work, now reap the benefits! Exhibiting at the Wilkin County Showcase is a memorable experience and we would love to have you join us this year!

If your child(ren) participated in the afterschool program at any of the area schools, they too have exhibits ready to go! Please reach out to the Wilkin County Extension Office for more information on how to participate in the Wilkin County Showcase in August. We would be happy to answer any questions you have!

Consider joining us for County Fair Orientation & the Summer Picnic

The county showcase can be an intimidating experience for first-timers. So, let us help ease that anxiety! We will have practice judging stations set up for non-animal exhibits, and will be offering tours of the 4-H canteen, livestock barns, and 4-H exhibit halls so you can find your way around the grounds before the fair begins. This is also an ideal time to ask any questions to staff or other seasoned families about the county showcase and fair!

County fair orientation will be held on July 29, 2025, at 5:30 p.m. Orientation will be held in conjunction with the summer picnic at Welles Memorial Park. All 4-H'ers and their families are invited to share a meal at this county-wide picnic. The picnic will be potluck style; you will be asked to bring something to share.

Other Important Events

Wilkin County Horse Show-August 9, 2025

Wilkin County Fair-August 21-24, 2025

Contact information

Wilkin County Extension Office

218-643-5481

mnext-wilkin@umn.edu

Extension Educator

Jessica Pauna

218-790-4266

pauna011@umn.edu

Information at your fingertips

Use the TeamReach app for more Wilkin County 4-H information with the Group Code: Wilkin4H